

Electrowelded Wire Mesh

Wire Mesh



Technical Features

Electrowelded wire mesh using steel quality **B500A** or **B500C**.

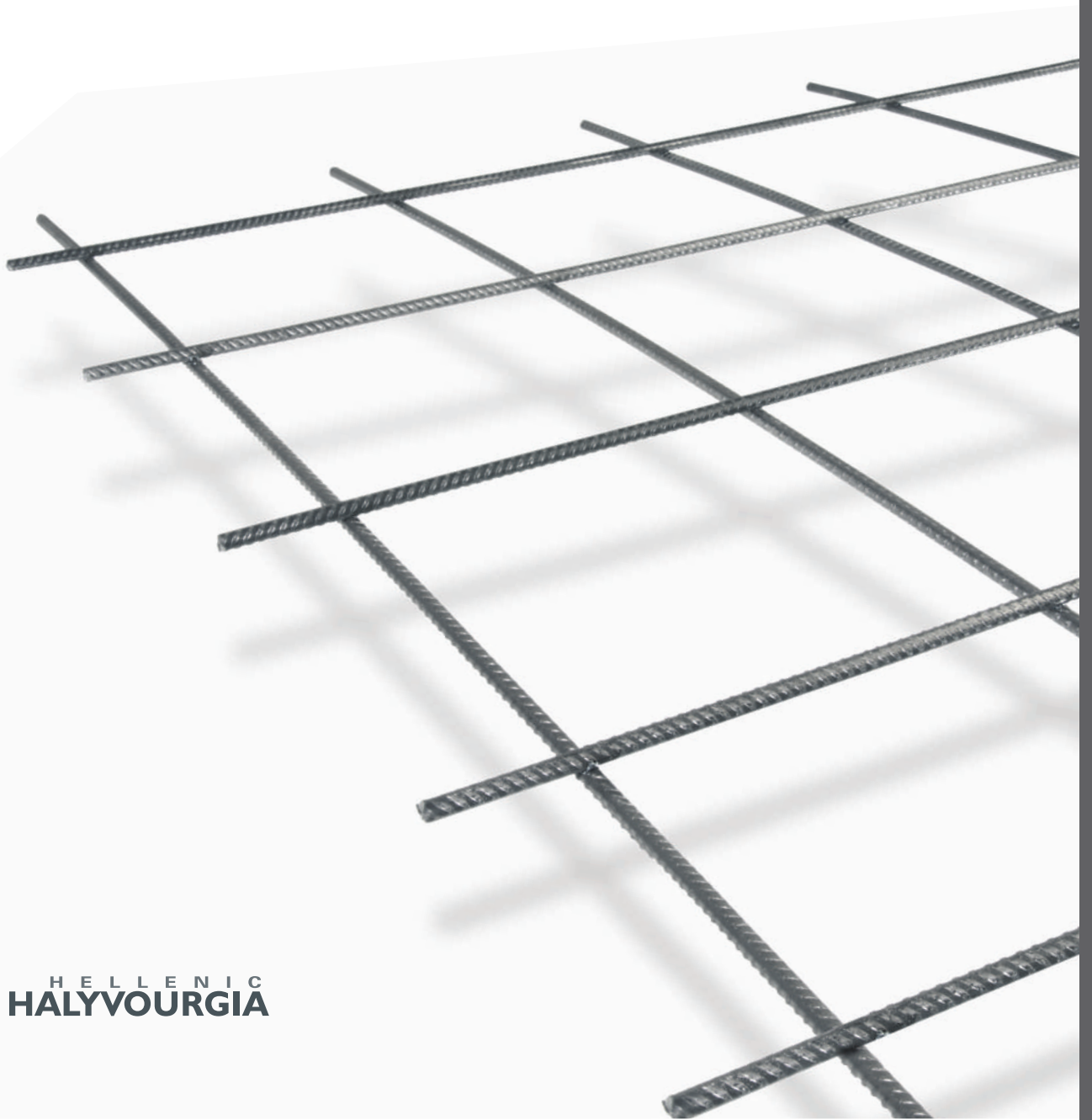

Electrowelded Wire Mesh

Wire Mesh

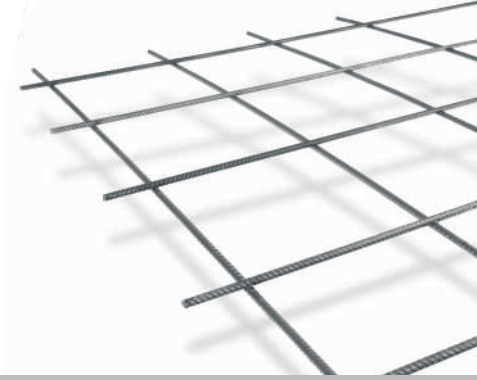

TYPES & TECHNICAL SPECIFICATIONS OF WIRE MESH

	Type Name	Dimensions LxW (m)	Longitudinal Wires			Transverse Wires			Nominal Sheet Weight (kg)	Sheet per Bundle (piece)	Nominal Bumble Weight (kg)	
			Wire Quantity	Diameter (mm)	Distances (mm)	Wire Quantity	Diameter (mm)	Distances (mm)				
WIRE MESH	O92	5,00x2,15	15	4,2	150	20	4,2	250	11,84	100	1184	
	T92	5,00x2,15	15	4,2	150	32	4,2	156	14,80	100	1480	
	TEΔ92	5,00x1,95	14	4,0	167	30	4,0	165	12,40	100	1240	
	TEΔ131	5,00x2,15	15	5,0	150	32	5,0	156	18,50	50	925	
	T139	5,00x2,15	22	4,2	100	50	4,2	100	22,00	50	1100	
	TEΔ251	3,60x2,15	10	8,0	200	18	8,0	200	25,80	50	1290	
	SPECIAL DIMENSIONS	T92-1,25	5,00x1,25	9	4,2	150	32	4,2	156	9,00	100	900
		T92-1,55	5,00x1,55	11	4,2	150	32	4,2	156	11,00	100	1100
T139-1,25		5,00x1,25	13	4,2	100	50	4,2	100	12,65	100	1265	
T139-1,55		5,00x1,55	16	4,2	100	50	4,2	100	15,60	100	1560	
WELDED FABRIC MESH	T196	5,00X2,15	22	5,0	100	50	5,0	100	31,70	50	1585	
	T131	5,00X2,15	15	5,0	150	32	5,0	156	21,20	50	1060	
	T188	5,00X2,15	15	6,0	150	32	6,0	156	30,30	50	1515	
	T251	3,60X2,15	10	8,0	200	18	8,0	200	28,00	50	1400	
	T393	3,60X2,15	10	10,0	200	17	10,0	200	45,29	30	1359	